

O-I Manufacturing France
 64 bd du 11 Novembre 1918 - BP 1228
 69611 Villeurbanne Cedex, France
 Tel. +33 (0)426686500

CONTAINER & MOULD ENGINEERING
EUROPE

NOTES:
 THIS DRAWING IS THE PROPERTY OF O-I AND
 MUST NOT BE REPRODUCED OR DISCLOSED
 WITHOUT O-I WRITTEN AUTHORIZATION.

ONLY TOLERANCED DIMENSIONS ARE GUARANTEED.

MANUFACTURING MARKINGS SHOWN ARE FOR ILLUSTRATIVE
 PURPOSES ONLY, ACTUAL MARKINGS ON CONTAINER
 MAY DIFFER, DEPENDANT ON LOCAL LEGISLATION.

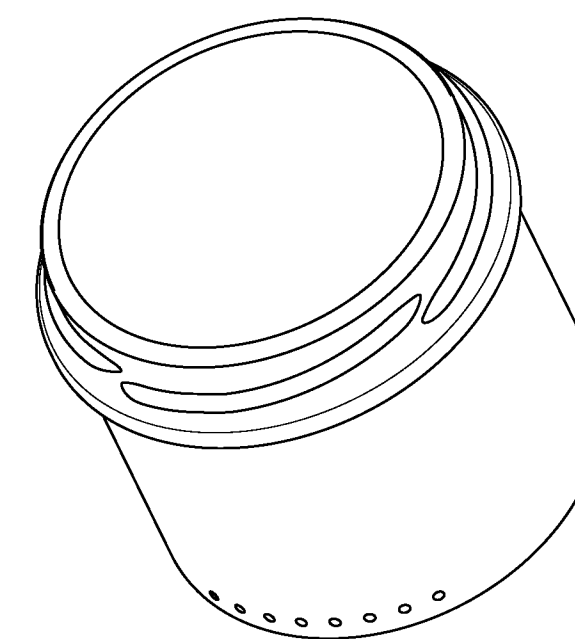
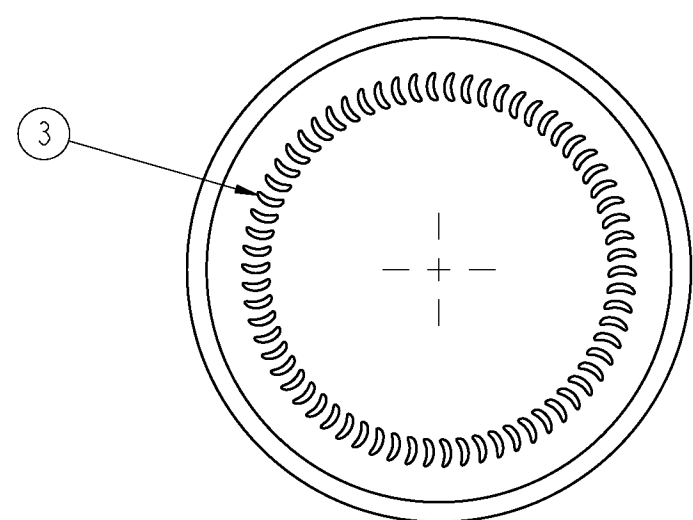
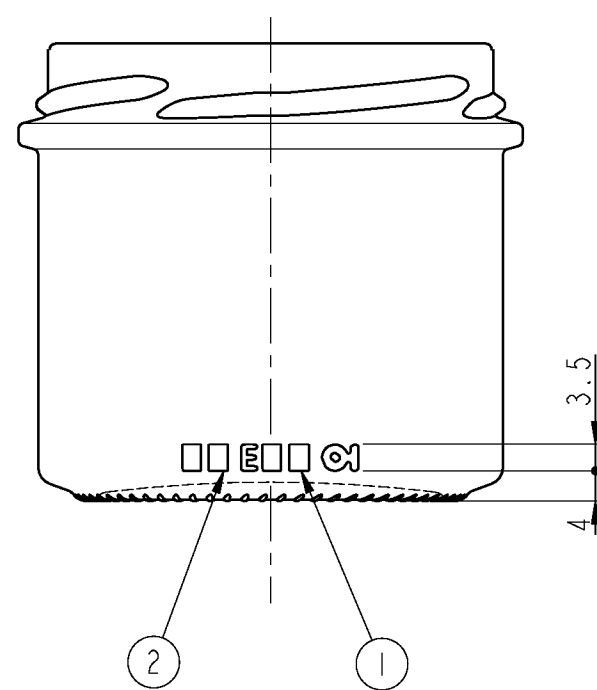
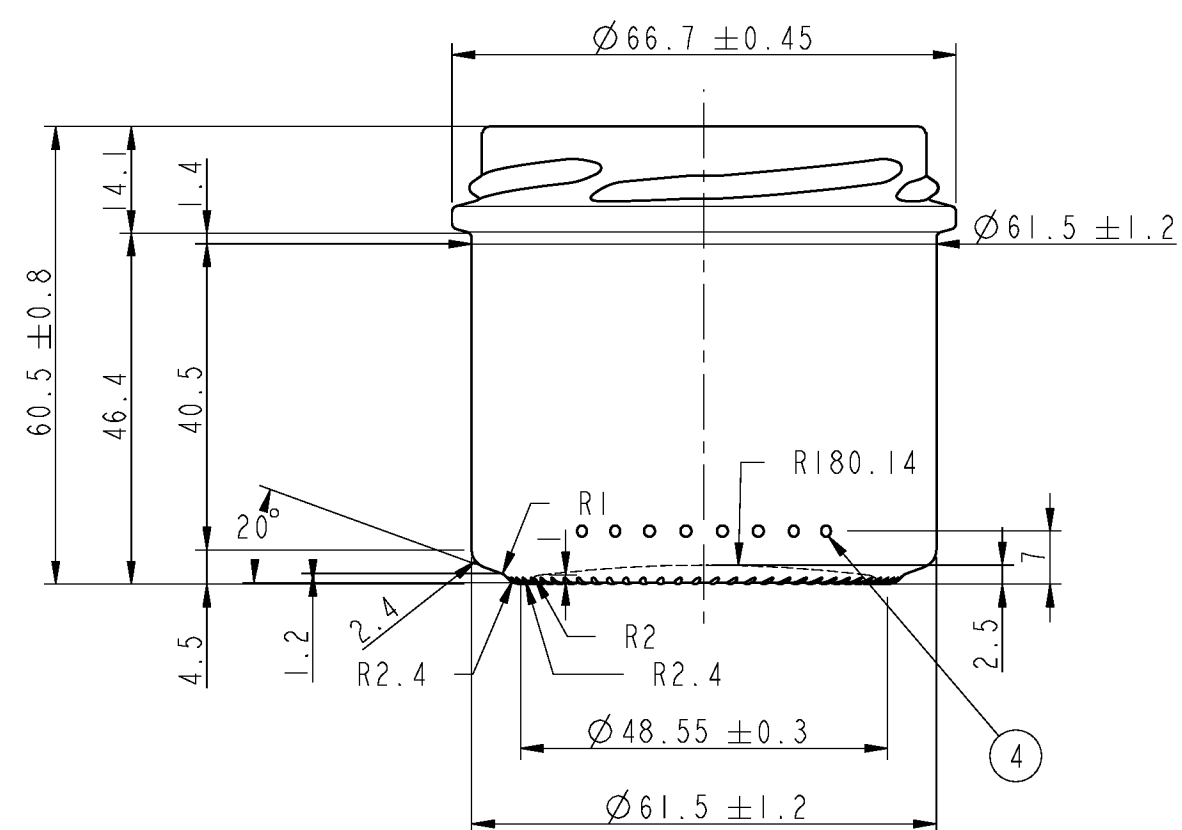

1 = TRADEMARK
 2 = CAVITY No.
 3 = STIPPLING
 THE SHAPE OF STIPPLES IS ONLY AN
 INDICATION AND THE CONSTRUCTION IS AT
 THE PRODUCTION PLANT DISCRETION.
 4 = CAVITY CODE

SCALE 1:1

TENTATIVE

HEAT TREATMENT XX °C maxi	CARBONATION XX g CO2/l maxi
VERTICAL LOAD 150 daN maxi	THERMAL SHOCK 42 °C maxi
CATEGORY FOOD	TILT ANGLE 42.23°
MAX. VERTICALITY TOLERANCE 1.5 mm	MEASURING CONTAINER NO
FINISH SAP NUMBER 3826	FINISH REF. CETIE GME 20-06 1995
MINIMUM THROUGH BORE mm	MAX FILLING TUBE Ø mm

CONTAINER OVERFLOW CAPACITY (BRIMFUL)
 130ml ± 3,8ml

CONTAINER RATED CAPACITY (FILLPOINT)
 NA

CONTAINER WEIGHT
 110g APPROX.

FINISH DESIGNATION
 FR_63_GME 20-06_H14I_3826

MAX GAS VOLUME
 NO

**STANDARD
 13 CL POT STD**

DESIGNER BCO DATE 25/03/10

CHECKED DATE

DRAWING NUMBER 100286_01
 MOULD/SAP NUMBER 000000

No	DATE	REVISIONS	DESIGN/CHECK